

0 1 2 3 4 5 6 7 8 9

A
B
C
D
E
F
G
H
I
J

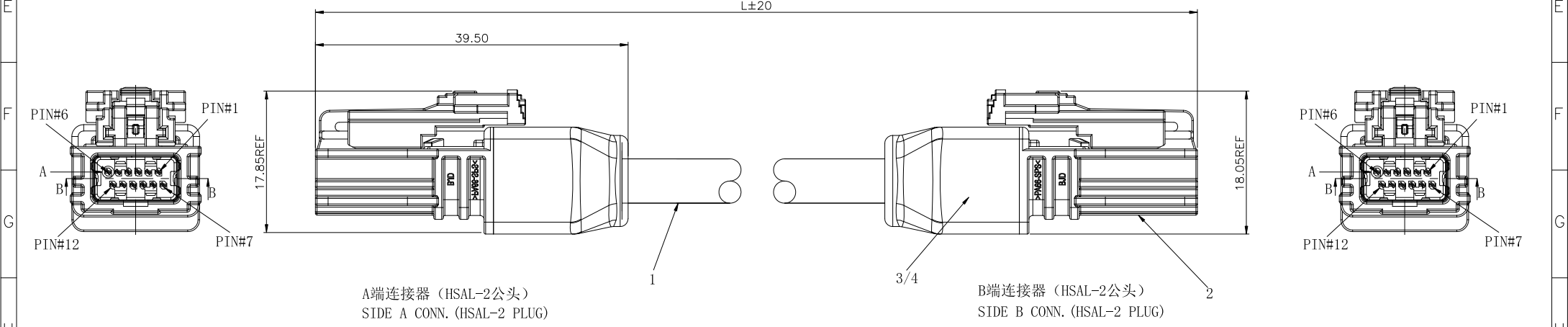
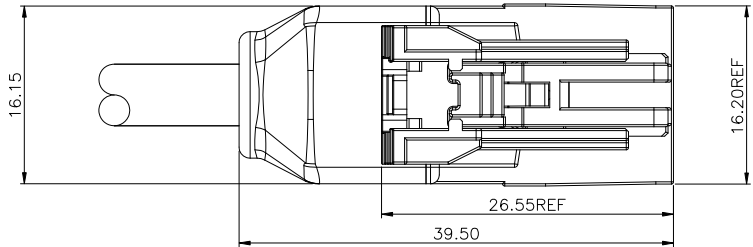
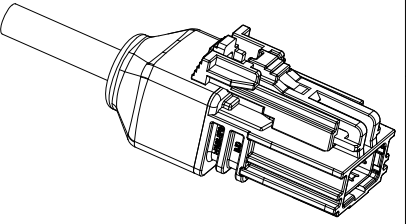

				UNLESS OTHERWISE SPECIFIED TOLERANCES ARE	客户图 Drawings		北极大电子科技有限公司 BEIJIDA ELECTRONICS TECHNOLOGY CO. LIMITED				
				X.		APPROVED	DATE	PART NO			
				X.X ±0.30		Jay	2023-05-05	160003-3XXXX01			
				X.XX ±0.20		CHECKED	DATE	NAME			
				X.XXX		Jay	2023-05-05	HSAL2 TO HSAL2 A/F CALBLE ASSEMBLY			
				ANG. ±2'		DRAWN	DATE	SIZE	SCALE	SHEET	REV
SER	REVISIONS	CHK	DATE	UNIT		Amy	2023-05-05	A4	4:1	1/2	X0
4		5		MM							
6		7									
8		9									

0 1 2 3 4 5 6 7 8 9

接线图
PIN OUT

A端连接器
SIDE A CONN.

B端连接器
SIDE B CONN.

PIN#		PIN#	PIN定义 (NAME)
1		1	GND
2		2	StdA_SSTX+
3		3	StdA_SSTX-
4		4	GND
5		5	StdA_SSRX+
6		6	StdA_SSRX-
7		7	VBUS
8		8	Open
9		9	D-
10		10	D+
11		11	Open
12		12	GND
Shield	Shield	Shield	

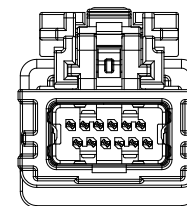

141091-421280
KEY OPTION "A"
COLOR:BLACK

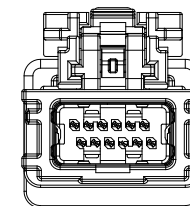

141091-421281
KEY OPTION "B"
COLOR:GREY

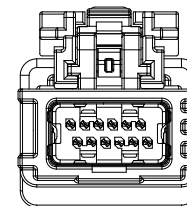

141091-421282
KEY OPTION "C"
COLOR:BROWN

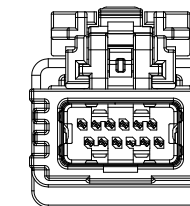

141091-421283
KEY OPTION "D"
COLOR:GREEN

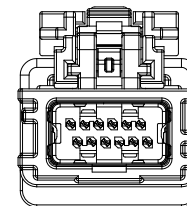

141091-421284
KEY OPTION "E"
COLOR:BLUE

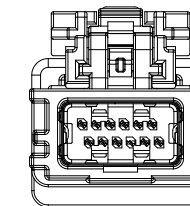

141091-421285
KEY OPTION "F"
COLOR:NATURAL

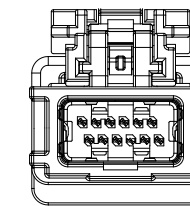

141091-421286
KEY OPTION "G"
COLOR:PURPLE

P/N SYSTEM:
160003-3XXXX01
01: KEY A TO KEY A
WIRE LENGTH CODE(mm)

4	OUTER MOLD	COLOR:BLACK
3	INNER MOLD	/
2	HSAL-2 PLUG CONN.	/
1	CALBE	USB3.0 28#X2P+28#X1P+24#X2C,OD:5.20
ITEM	PART NAME	REMARKS

SER	REVISIONS	CHK	DATE

UNIT	MM

客户图 Drawings	
APPROVED Jay	DATE 2023-05-05
CHECKED Jay	DATE 2023-05-05
DRAWN Amy	DATE 2023-05-05

客户图 Drawings											
北极大电子科技有限公司 BEIJIDA ELECTRONICS TECHNOLOGY CO. LIMITED											
APPROVED Jay		DATE 2023-05-05		PART NO 160003-3XXXX01		NAME HSAL2 TO HSAL2 A/F CALBLE ASSEMBLY					
CHECKED Jay		DATE 2023-05-05		DRAWN Amy		DATE 2023-05-05		SIZE A4	SCALE 4:1	SHEET 2/2	REV X0