

RECOMMENDED P.C.B LAYOUT
TOLERANCE: ±0.05
(BOTTOM VIEW)

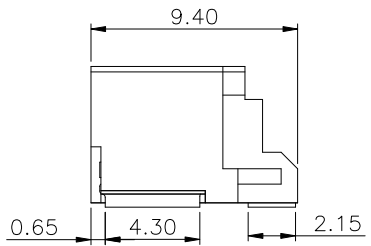

NOTES:
VOLTAGE RATING: 250V AC/DC MAX.
CURRENT RATING: 3A AC/DC (HIGHER CURRENT RATING ACHIEVABLE, CONTACT SALES FOR ADDITIONAL TECHNICAL INFORMATION).
WITHSTANDING VOLTAGE: 800V AC/MINUTE
TEMPERATURE RANGE: -40°C ~ +125°C
INSULATION RESISTANCE: ≥1000MΩ
CONTACT RESISTANCE: ≤10mΩ
AFTER ENVIRONMENTAL TESTING: ≤20mΩ
APPLICABLE BJD HSG: 24104X-07XX05

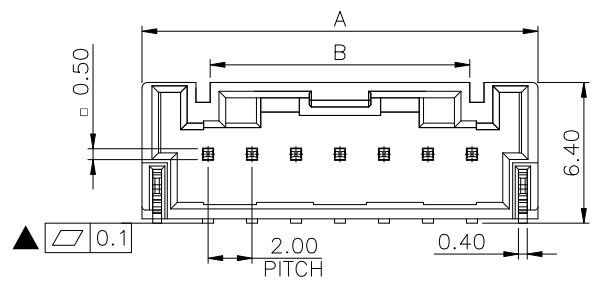
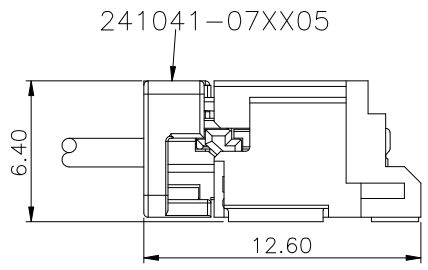
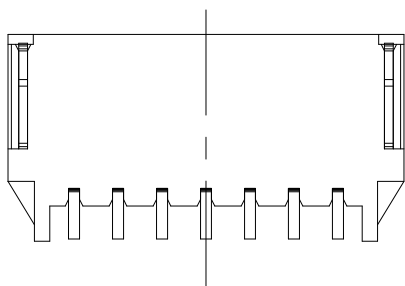

MATED DIMENSION

P/N SYSTEM:
141041-21 XX 10
— PIN NO.
02-02PIN
03-03PIN
... ..

3	SOLDERING PIN	2	COPPER ALLOY	MATTE TIN PLATED OVER NICKEL
2	CONTACT PIN	N	COPPER ALLOY	MATTE TIN PLATED OVER NICKEL
1	HOUSING	1	PA9T,COLOR:NATURAL	
ITEM	PART NAME	Q'TY	MATERIAL	FINISH

X2	ADD NEW OPTION	Jay	2023-09-26
X1	ADD MISSING DIMENSIONS	Jay	2022-03-17
X0	INITIAL REVISION	Jay	2021-03-24
SER	REVISIONS	CHK	DATE

UNLESS OTHERWISE SPECIFIED TOLERANCES ARE	
X.	
X.X	±0.30
X.XX	±0.20
X.XXX	
ANG.	±2'

客户图 Drawings		北极大电子科技有限公司 BEIJIDA ELECTRONICS TECHNOLOGY CO. LIMITED					
APPROVED Jay	DATE 2021-03-24	PART NO 141041-21XX10					
CHECKED Jay	DATE 2021-03-24	NAME 2.00mm R/A SMT WAFER					
DRAWN Bob	DATE 2021-03-24	SIZE A4	SCALE 3:1	SHEET 1/2	REV X2		

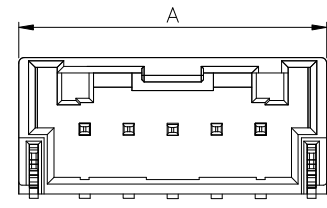
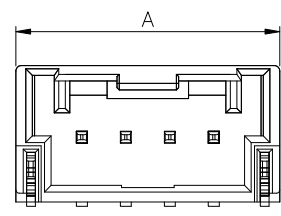
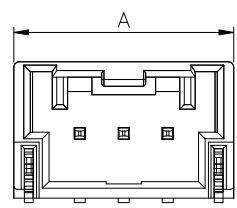
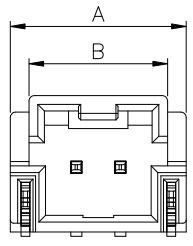
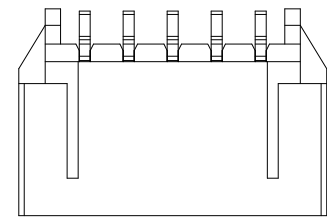
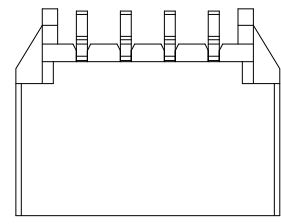
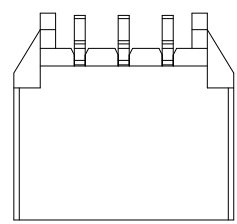
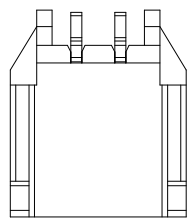

2PIN

3PIN

4PIN

5PIN

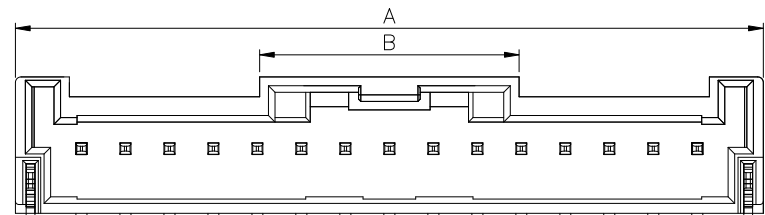
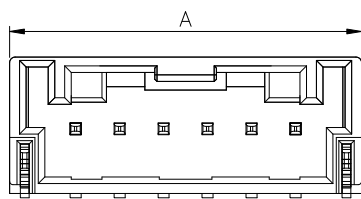
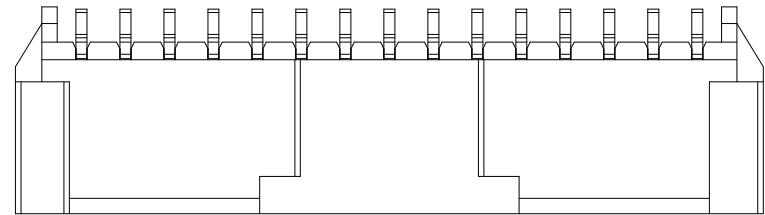
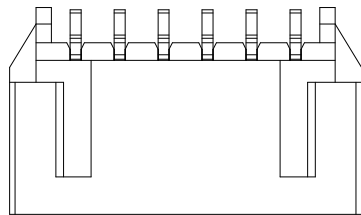

6PIN

7~15PIN

PIN NO.	DIM.	
	A	B
02	8.00	6.30
03	10.00	
04	12.00	
05	14.00	
06	16.00	
07	18.00	11.80
08	20.00	11.80
09	22.00	11.80
10	24.00	11.80
11	26.00	11.80
12	28.00	11.80
13	30.00	11.80
14	32.00	11.80
15	34.00	11.80

X2	ADD NEW OPTION	Jay	2023-09-26
X1	ADD MISSING DIMENSIONS	Jay	2022-03-17
X0	INITIAL REVISION	Jay	2021-03-24
SER	REVISIONS	CHK	DATE

UNLESS OTHERWISE SPECIFIED TOLERANCES ARE
 X. ±0.30
 X.X ±0.20
 X.XX ±0.20
 X.XXX ±0.20
 ANG. ±2'

客户图
Drawings
 APPROVED
 Jay
 CHECKED
 Jay
 DRAWN
 Bob

北极大电子科技有限公司
 BEIJIDA ELECTRONICS TECHNOLOGY CO. LIMITED
 APPROVED DATE 2021-03-24 PART NO 141041-21XX10
 CHECKED DATE 2021-03-24 NAME 2.00mm R/A SMT WAFER
 DRAWN DATE 2021-03-24 SIZE A4 SCALE 3:1 SHEET 2/2 REV X2

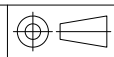

0 1 2 3 4 5 6 7 8 9

A B C D E F G H I J

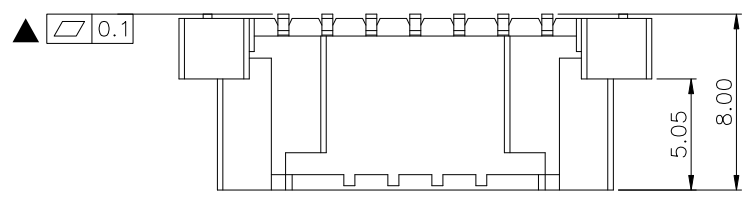
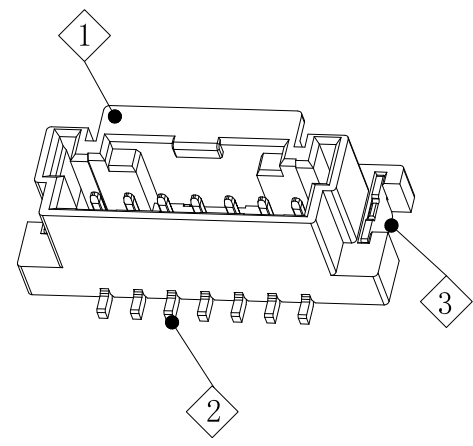
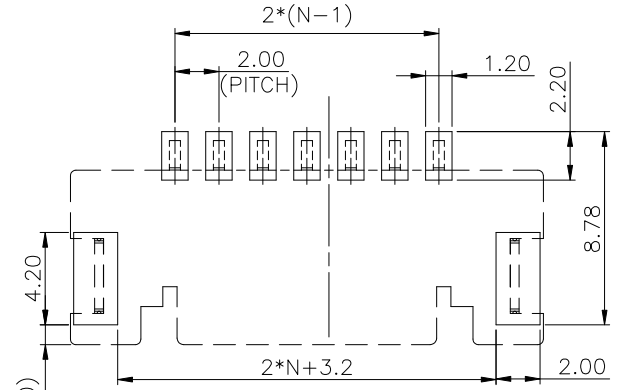
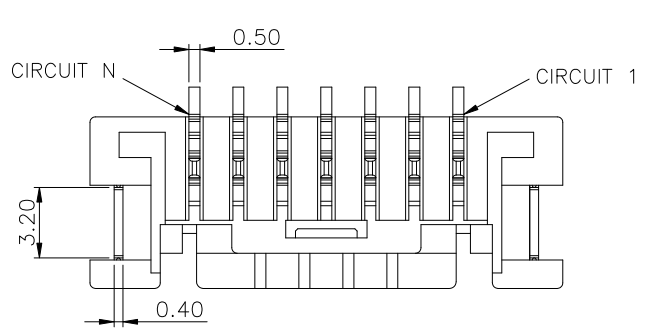

RECOMMENDED P.C.B LAYOUT
TOLERANCE: ±0.05
(BOTTOM VIEW)

NOTES:
VOLTAGE RATING: 250V AC/DC MAX.
CURRENT RATING: 3A AC/DC(HIGHER CURRENT RATING ACHIEVABLE, CONTACT SALES FOR ADDITIONAL TECHNICAL INFORMATION).
WITHSTANDING VOLTAGE: 800V AC/MINUTE
TEMPERATURE RANGE: -40°C ~ +125°C
INSULATION RESISTANCE: ≥1000MΩ
CONTACT RESISTANCE: ≤10mΩ
AFTER ENVIRONMENTAL TESTING: ≤20mΩ
APPLICABLE BJD HSG: 24104X-07XX05

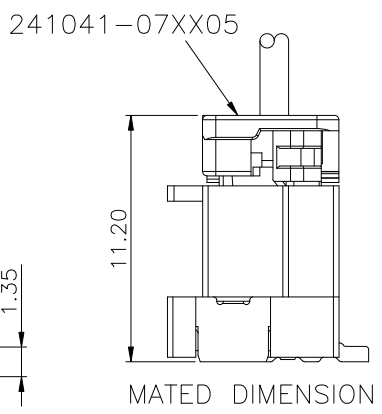
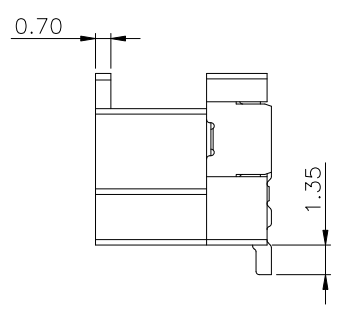
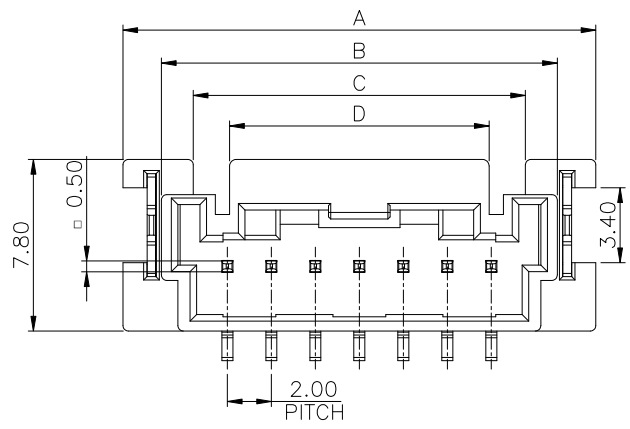

MATED DIMENSION

P/N SYSTEM:
141041-22 XX 10
PIN NO.
02-02PIN
03-03PIN
... ..

4	PICK UP CAP	1	HIGH TEMPERATURE THERMOPLASTIC	
3	SOLDERING PIN	2	COPPER ALLOY	MATTE TIN PLATED OVER NICKEL
2	CONTACT PIN	N	COPPER ALLOY	MATTE TIN PLATED OVER NICKEL
1	HOUSING	1	PA9T,COLOR:NATURAL	
ITEM	PART NAME	Q'TY	MATERIAL	FINISH

					UNLESS OTHERWISE SPECIFIED TOLERANCES ARE
					X. ±0.30
					X.X ±0.20
					X.XX ±0.20
					X.XXX ±0.20
					ANG. ±2'
X2	ADD NEW OPTION	Jay	2023-09-26		
X1	ADD MISSING DIMENSIONS	Jay	2022-03-17		
X0	INITIAL REVISION	Jay	2021-03-24		
SER	REVISIONS	CHK	DATE	UNIT	MM

客户图 Drawings		北极大电子科技有限公司 BEIJIDA ELECTRONICS TECHNOLOGY CO. LIMITED					
APPROVED Jay	DATE 2021-03-24	PART NO 141041-22XX10					
CHECKED Jay	DATE 2021-03-24	NAME 2.00mm VTL SMT WAFER					
DRAWN Bob	DATE 2021-08-09	SIZE A4	SCALE 3:1	SHEET 1/2	REV X2		

0 1 2 3 4 5 6 7 8 9

INTERFACE PROFILE SHOWN WITH PICK UP CAP

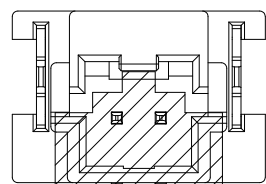

2PIN

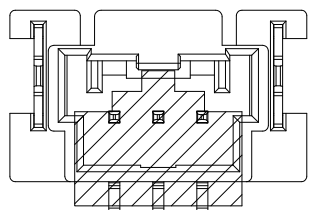

3PIN

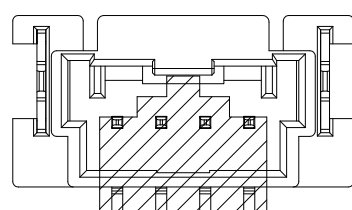

4PIN

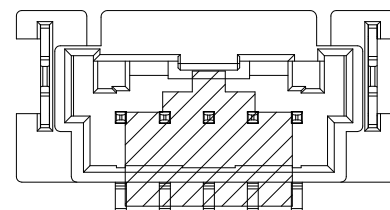

5PIN

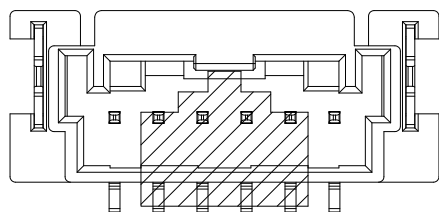
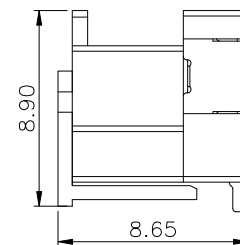

6PIN

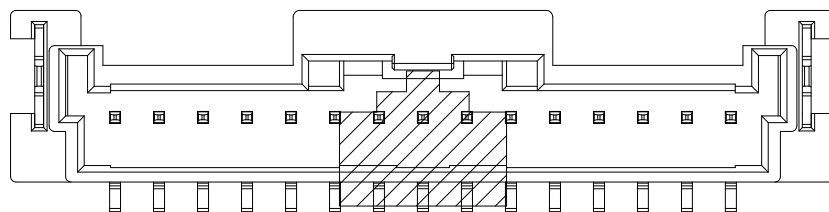

7~15PIN

PIN NO.	DIM.			
	A	B	C	D
02	11.50	8.00	6.30	6.30
03	13.50	10.00	7.10	5.80
04	15.50	12.00	9.10	7.80
05	17.50	14.00	11.10	9.80
06	19.50	16.00	13.10	11.80
07	21.50	18.00	15.10	11.80
08	23.50	20.00	17.10	11.80
09	25.50	22.00	19.10	11.80
10	27.50	24.00	21.10	11.80
11	29.50	26.00	23.10	11.80
12	31.50	28.00	25.10	11.80
13	33.50	30.00	27.10	11.80
14	35.50	32.00	29.10	11.80
15	37.50	34.00	31.10	11.80

SER	REVISIONS	CHK	DATE
X2	ADD NEW OPTION	Jay	2023-09-26
X1	UPDATE THE DRAWING	Jay	2022-03-17
X0	INITIAL REVISION	Jay	2021-03-24

UNLESS OTHERWISE SPECIFIED TOLERANCES ARE	
X.	
X.X	±0.30
X.XX	±0.20
X.XXX	
ANG.	±2'
UNIT	MM

客户图 Drawings	
APPROVED	DATE
Jay	2021-03-24
CHECKED	DATE
Jay	2021-03-24
DRAWN	DATE
Bob	2021-03-24

客户图 Drawings				北极大电子科技有限公司 BEIJIDA ELECTRONICS TECHNOLOGY CO. LIMITED			
APPROVED		DATE		PART NO		NAME	
Jay		2021-03-24		141041-22XX10		2.00mm VTL SMT WAFER	
DRAWN		DATE		SIZE	SCALE	SHEET	REV
Bob		2021-03-24		A4	3:1	2/2	X2

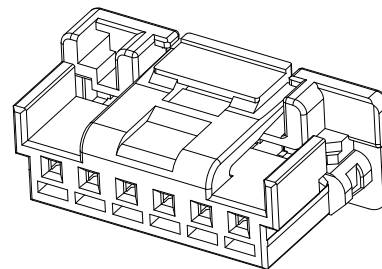
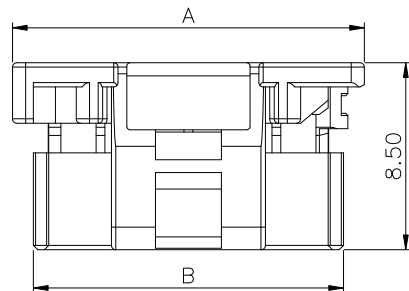

PIN NO.	DIM.				
	A	B	C	D	E
02	8.00	6.10	4.70	3.35	4.70
03	10.00	8.10	4.90	3.50	6.70
04	12.00	10.10	6.90	5.60	8.70
05	14.00	12.10	7.00	5.60	10.70
06	16.00	14.10	7.00	5.60	12.70
07	18.00	16.10	7.00	5.60	14.70
08	20.00	18.10	7.00	5.60	16.70
09	22.00	20.10	7.00	5.60	18.70
10	24.00	22.10	7.00	5.60	20.70
11	26.00	24.10	7.00	5.60	22.70
12	28.00	26.10	7.00	5.60	24.70
13	30.00	28.10	7.00	5.60	26.70
14	32.00	30.10	7.00	5.60	28.70
15	34.00	32.10	7.00	5.60	30.70

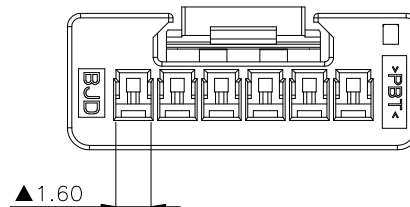
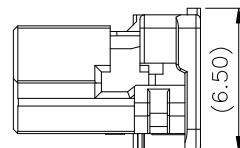
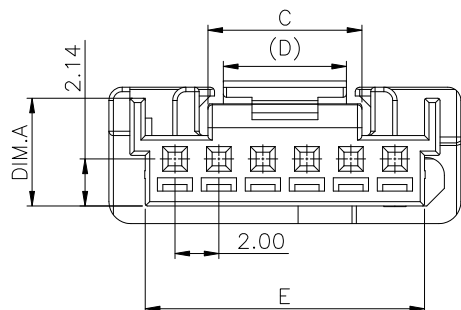

NOTES:
 VOLTAGE RATING: 250V AC/DC MAX.
 CURRENT RATING: 3A AC/DC(HIGHER CURRENT RATING ACHIEVABLE, CONTACT SALES FOR ADDITIONAL TECHNICAL INFORMATION).
 WITHSTANDING VOLTAGE: 800V AC/MINUTE
 TEMPERATURE RANGE: -40°C ~ +125°C
 INSULATION RESISTANCE: ≥1000MΩ
 CONTACT RESISTANCE: ≤10mΩ
 AFTER ENVIRONMENTAL TESTING: ≤20mΩ
 MATERIAL: PBT
 APPLICABLE

BJD WAFER: 141041-21XX10
 BJD TPA: 241041-09XX06
 BJD TERMINAL: 241041-0811X0

P/N SYSTEM:

24104X-07 XX 05

1: DIM.A=4.90, WHITE PIN NO.
 2: DIM.A=3.70, WHITE 02-02PIN
 3: DIM.A=3.70, BLACK 03-03PIN

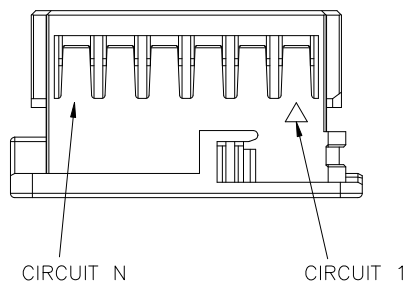

				UNLESS OTHERWISE SPECIFIED TOLERANCES ARE		客户图 Drawings		北极大电子科技有限公司 BEIJIDA ELECTRONICS TECHNOLOGY CO. LIMITED					
				X.		APPROVED	DATE	PART NO					
X3	MODIFY THE SIZE	Jay	2023-02-22	X.X	±0.30	Jay	2021-03-24	24104X-07XX05					
X2	ADD NEW OPTION	Jay	2022-04-15	X.XX	±0.20	CHECKED	DATE	NAME					
X1	UPDATE THE DRAWING	Jay	2022-04-03	X.XXX		Jay	2021-03-24	2.00mm WTB HOUSING					
X0	INITIAL REVISION	Jay	2021-03-24	ANG.	±2'	DRAWN	DATE	SIZE	SCALE	SHEET	REV		
SER	REVISIONS	CHK	DATE	MM		Bob	2021-03-24	A4	3:1	1/2	X3		

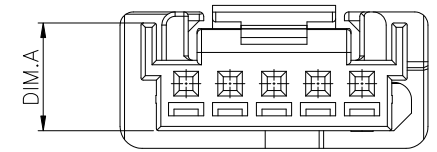
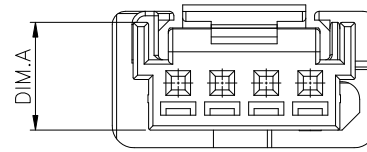
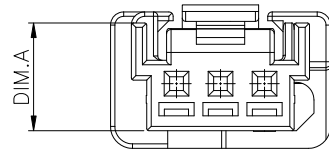
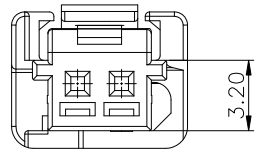
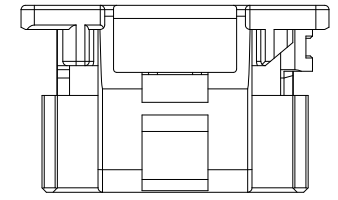
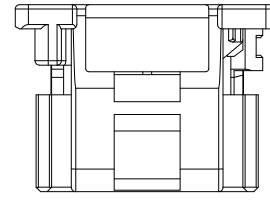
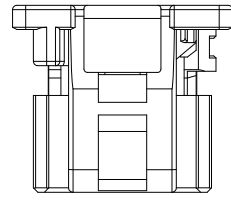
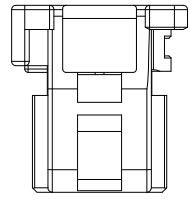

2PIN

3PIN

4PIN

5PIN

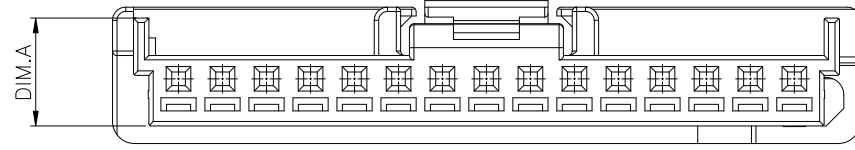
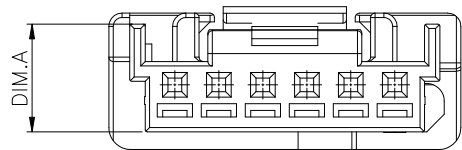
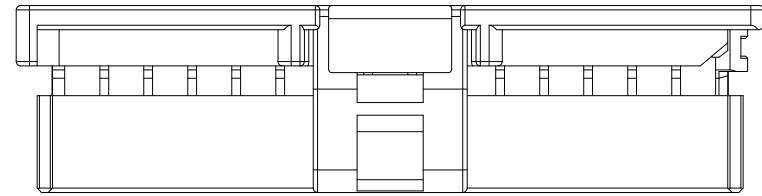
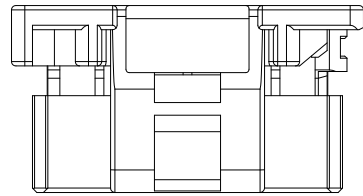

6PIN

7~15PIN

				UNLESS OTHERWISE SPECIFIED TOLERANCES ARE	客户图 Drawings	北极大电子科技有限公司 BEIJIDA ELECTRONICS TECHNOLOGY CO. LIMITED				
				X. X.X ±0.30 X.XX ±0.20 X.XXX	APPROVED Jay	DATE 2021-03-24	PART NO 24104X-07XX05			
X2	ADD NEW OPTION	Jay	2022-04-15	ANG. ±2'	CHECKED Jay	DATE 2021-03-24	NAME 2.00mm WTB Housing			
X0	INITIAL REVISION	Jay	2021-03-24	UNIT	DRAWN	DATE	SIZE	SCALE	SHEET	REV
SER	REVISIONS	CHK	DATE	MM	Bob.Jiang	2021-03-24	A4	3:1	2/2	X2

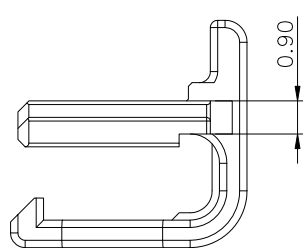

2PIN

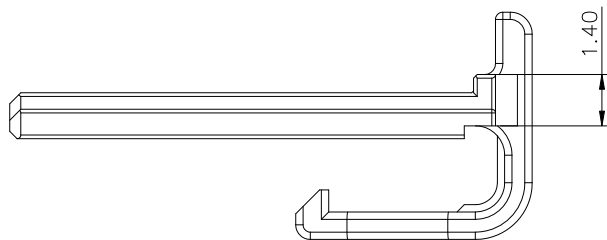

3~15PIN

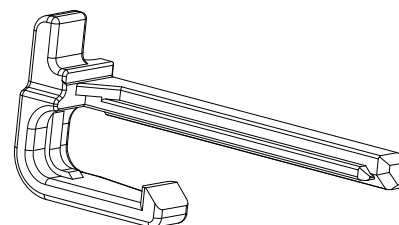

PIN NO.	DIM.
	A
02	6.25
03	8.25
04	10.25
05	12.25
06	14.25
07	16.25
08	18.25
09	20.25
10	22.25
11	24.25
12	26.25
13	28.25
14	30.25
15	32.25

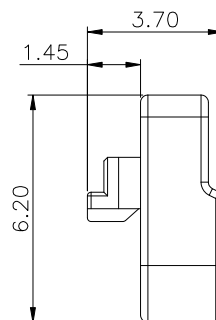
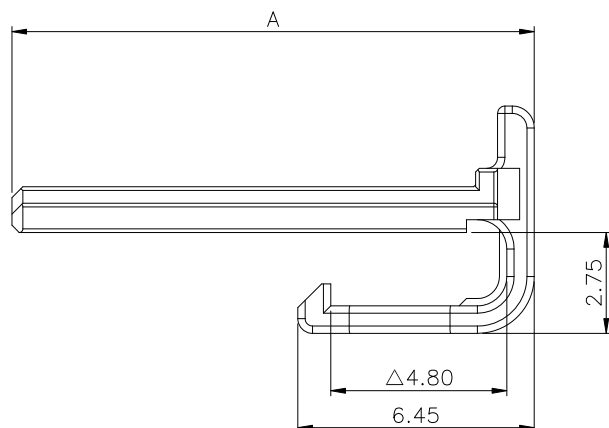
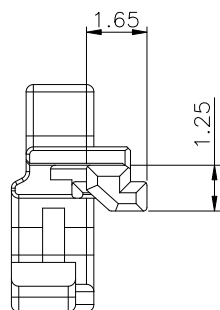

NOTES:
 VOLTAGE RATING: 250V AC/DC MAX.
 CURRENT RATING: 3A AC/DC(HIGHER CURRENT RATING ACHIEVABLE, CONTACT SALES FOR ADDITIONAL TECHNICAL INFORMATION).
 WITHSTANDING VOLTAGE: 800V AC/MINUTE
 TEMPERATURE RANGE: -40°C ~ +125°C
 INSULATION RESISTANCE: ≥1000MΩ
 CONTACT RESISTANCE: ≤10mΩ
 AFTER ENVIRONMENTAL TESTING: ≤20mΩ

MATERIAL:PBT BLACK

APPLICABLE
 BJD HSG: 24104X-07XX05

P/N SYSTEM:
 241041-09 XX 06

PIN NO.
 02-02PIN
 03-03PIN

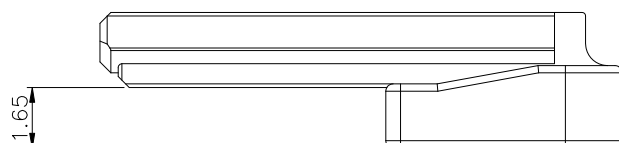

SER	REVISIONS	CHK	DATE
X1	ADD COLOR TO MATERIAL	Jay	2024-01-08
X0	INITIAL REVISION	Jay	2021-03-24

UNLESS OTHERWISE SPECIFIED TOLERANCES ARE	UNIT
X. ±0.30	MM
X.XX ±0.20	
X.XXX	
ANG. ±2'	

客户图 Drawings		客户图			
APPROVED		DATE		PART NO	
Jay		2021-03-24		241041-09XX06	
CHECKED		DATE		NAME	
Jay		2021-03-24		2.00mm WTB TPA	
DRAWN	DATE	SIZE	SCALE	SHEET	REV
Bob	2021-03-24	A4	5:1	1/1	X1

客户图
 北极大电子科技有限公司
 BEIJIDA ELECTRONICS TECHNOLOGY CO. LIMITED

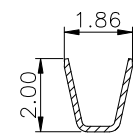
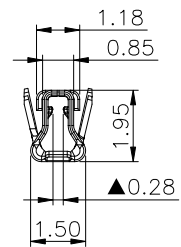
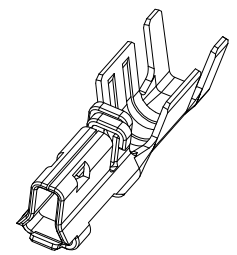
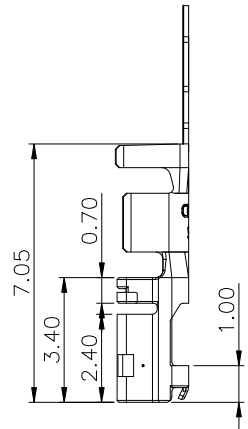
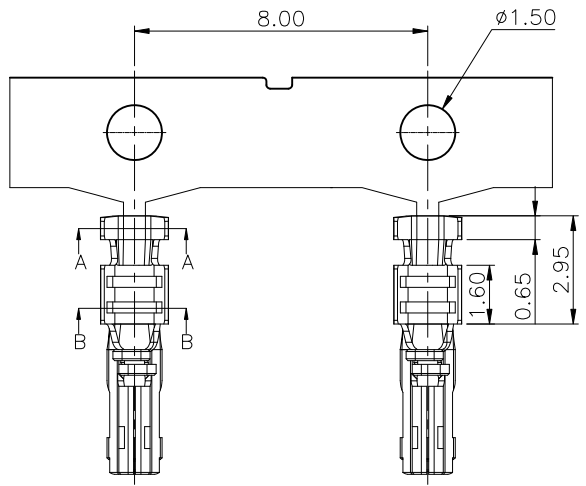

SECTION A-A

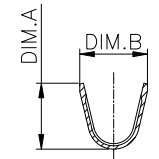

SECTION B-B

NOTES:
 VOLTAGE RATING: 250V AC/DC MAX.
 CURRENT RATING: 3A AC/DC(HIGHER CURRENT RATING ACHIEVABLE,CONTACT SALES FOR ADDITIONAL TECHNICAL INFORMATION).
 WITHSTANDING VOLTAGE: 800V AC/MINUTE
 TEMPERATURE RANGE: -40°C ~ +125°C
 INSULATION RESISTANCE: ≥1000MΩ
 CONTACT RESISTANCE: ≤10mΩ
 AFTER ENVIRONMENTAL TESTING: ≤20mΩ

MATERIAL: PHOSPHOR BRONZE
 PLATING: 120u”(1~3um)NI,80~200u”(2~5um)TIN
 APPLICABLE BJD HOUSING: 24104X-07XX05

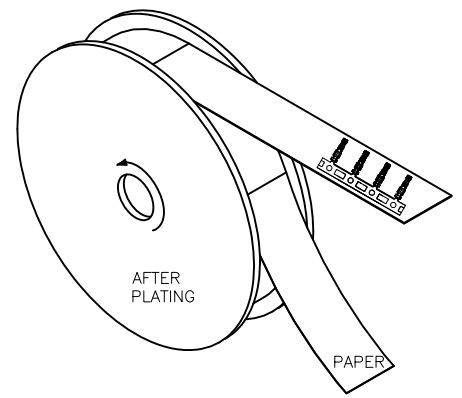

241041-081150	0.35mm ² ~0.50mm ² (22 AWG~20 AWG) OD=1.60 MAX.	1.80	1.85
241041-081160	0.22mm ² ~0.13mm ² (24 AWG~26 AWG) OD=1.20 MAX.	1.22	1.58
P/N	WIRE SIZE	DIM.A	DIM.B

					UNLESS OTHERWISE SPECIFIED TOLERANCES ARE
					X. ±0.30
					X.X ±0.20
					X.XXX
					ANG. ±2'
X1	MODIFY WIRE SIZE	Jay	2022-05-12	UNIT	MM
X0	INITIAL REVISION	Jay	2021-03-24		
SER	REVISIONS	CHK	DATE		

客户图 Drawings		北极大电子科技有限公司 BEIJIDA ELECTRONICS TECHNOLOGY CO. LIMITED							
APPROVED Jay	DATE 2021-03-24	PART NO 241041-0811X0							
CHECKED Jay	DATE 2021-03-24	NAME 2.00mm WTB TERMINAL							
DRAWN Bob	DATE 2021-03-24	SIZE A4	SCALE 5:1	SHEET 1/1	REV X1				